



EBURY STREET,
BELGRAVIA VILLAGE, SW1W

EBURRY

STRE

SW1

TABLE OF CONTENTS

HOME FEATURES	1
KITCHEN & RECEPTION	2
BEDROOMS & BATHROOMS	3-4
EXTERIOR	5
FLOORPLANS & EPC	6
LOCATION & MAP	7
LOCAL AMENITIES	8-9
CONTACT	10



HOME FEATURES & SPECIFICATIONS

Introducing this one-bedroom raised ground floor flat on Ebury Street, Belgravia. Set over 450 sq ft, the flat features high ceilings and good natural light throughout. It includes a good-sized reception room, double bedroom with fitted storage, separate kitchen, and a bathroom. Furnished and available now to rent.

The property is moments from Eccleston Yards, a trendy destination offering a variety of boutiques, cafes, and restaurants, as well as the charm of Elizabeth Street with its high-end shops and eateries. Both areas are part of Belgravia's vibrant community, offering a blend of convenience and luxury in a prime central location.

1 DOUBLE BEDROOM

RECEPTION

SEPARATE KITCHEN

BATHROOM

HIGH CEILINGS

AMPLE FITTED STORAGE

PRIME CENTRAL LOCATION

PRICE

£700pw (Long let)

LOCAL AUTHORITY

City of Westminster

COUNCIL TAX

Band E

FURNISHINGS

Furnished

AVAILABLE NOW

VIDEO

<https://vimeo.com/1056458350?share=copy>

KITCHEN & RECEPTION



Reception



Kitchen

BEDROOMS & BATHROOMS



Bedroom



Bathroom



Exterior

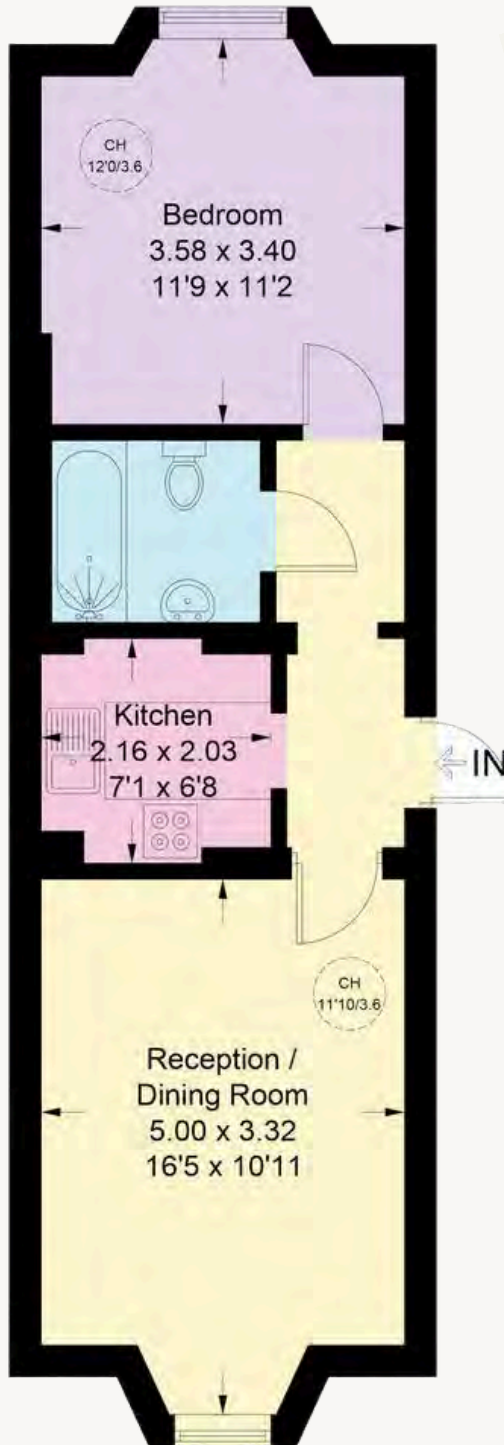

RAISED GROUND FLOOR

FLOOR PLANS & EPC

**TOTAL
APPROXIMATE GROSS INTERNAL AREA**

450 sq ft / 41.8 sq m

CH = Ceiling Height

EPC RATING

C

Certificate No.

7590-0075-0922-6496-3243

Score	Energy rating	Current	Potential
92+	A		
81-91	B		
69-80	C	71 C	79 C
55-68	D		
39-54	E		
21-38	F		
1-20	G		

LOCATION & MAP

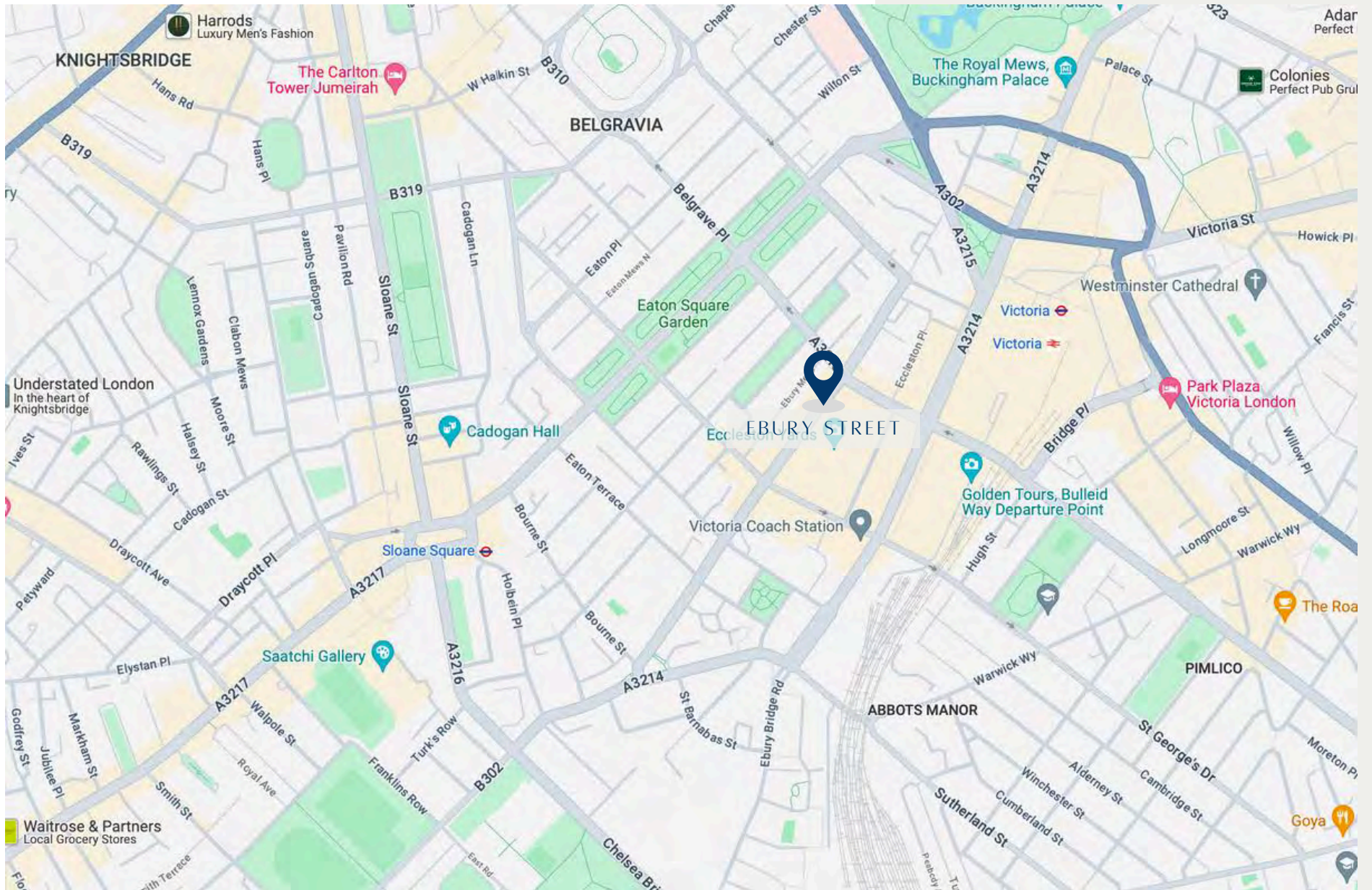

FIND CAFES, SHOPS, & BAKERIES AT EVERY CORNER

Belgravia exudes sophistication with its elegant, historic architecture and upscale amenities. Just around the corner, you'll find Elizabeth Street, known for its charming village atmosphere, characterised by cobblestones, local bakeries, cafes, boutiques and restaurants. The neighbourhood captures the essence of luxury living with a real sense of community in the heart of London.

Ebury Street is eligible upon application for access to Belgrave Square gardens and tennis courts for a nominal fee. Battersea Park is just across the river and St. James' Park, Hyde Park and Green Park are also nearby.

RESTAURANTS

OLIVETO

61 Elizabeth St
SW1W 9PP

THOMAS CUBITT

44 Elizabeth St
SW1W 9PA

GROCERIES

BAYLEY & SAGE

141 Ebury St
SW1W 9QW

WAITROSE

27 Motcomb St
SW1X 8GG

CAFES & BAKERIES

TOM TOM

114 Ebury St,
SW1W 9QD

POILANE

46 Elizabeth St,
SW1W 9PA

SCHOOLS

EATON SQUARE SCHOOL

55-57 Eccleston Square,
SW1V 1PH

FRANCIS HOLLAND

39 Graham Terrace
SW1W 8JF

SHOPPING

ELIZABETH STREET

120 yards

KINGS ROAD

0.3 miles

TRANSPORT LINKS

VICTORIA STATION

Train links to Gatwick, Heathrow, the Southwest and Brighton. District & Circle and Victoria lines

SLOANE SQUARE

District & Circle Lines



BELGRAVIA





Details Prepared February 2024

GET IN TOUCH

CONTACT INFORMATION

E: LETTINGS@WELLBELOVE-QUESTED.COM

P: 020 7881 0880 / 07719039888

40 EATON TERRACE, BELGRAVIA, LONDON, SW1W 8TS

ELLEN MEEKIN - SALES & LETTINGS NEGOTIATOR

E: E.ELLEN@WELLBELOVE-QUESTED.COM
M: 07719039888

GRANT WELLBELOVE - DIRECTOR

E: E.GRANT@WELLBELOVE-QUESTED.COM
M: 07595116210

ANDREW QUESTED - DIRECTOR

E: A.ANDREW@WELLBELOVE-QUESTED.COM
M: 07595116211

*The owner of this property is also the Director of Wellbelove Quested Ltd. Whilst every effort has been made to ensure that this brochure is accurate and up-to-date, prospective tenants should be aware that the owner is acting both as the landlord and the estate agent in this transaction.

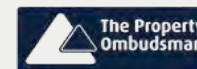

These particulars have been produced as a general guide for this property only and no other purpose. They are not an offer or contract. You should not rely on statements in these particulars or by word of mouth or in writing as being factually accurate about the property, its condition or its value. Neither any primary agent or joint agent has any authority to make or give any representations or warranties in relation to the property, and accordingly any information given is entirely without responsibility on the part of the agent or lessor(s). The photographs show only certain parts of the property as they appeared at the time they were taken. Any areas, measurements and distances given are approximate only. Any reference to alterations to, or use of, any part of the property does not mean that any necessary planning, building regulations or other consent has been obtained nor have any services, equipment or facilities been tested. A lessee should satisfy themselves by inspection or otherwise. The VAT position relating to the property may change without notice. Please contact us for further information regarding the approved Client Money Protection (CMP) scheme and the property redress scheme which we are a member of.